

**PRASA**

## **PRASA -CARROCERIA**

- CIERRES
- CERROJOS
- ACCESORIOS PARA  
CONTENEDORES Y BASCULANTES
- MACHOS
- HEMBRAS
- PILARES Y CUÑAS DE LLANTA
- GANCHOS Y PRECINTOS
- BISAGRAS
- TORNOS
- ACCESORIOS VARIOS  
DE CARROCERIA
- ACCESORIOS AGRICOLAS

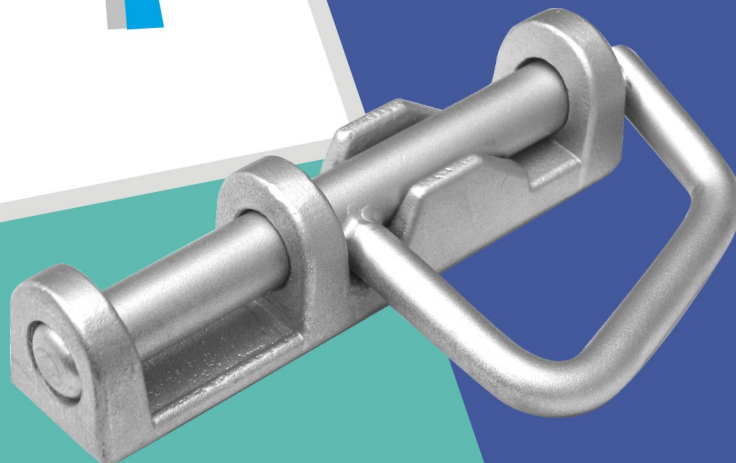

**PROVEEDORA ASTUR-ANDALUZA, S.L.**

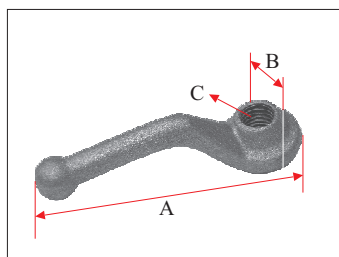

T-1 5/8" ; T-16 ; T-2 3/4"  
T-20 ; T-3 7/8" ; T-4 1"

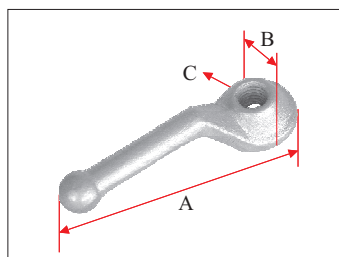

T-1 5/8"Z ; T-16 Z ; T-2 3/4"Z  
T-20 Z ; T-3 7/8"Z ; T-4 1"Z

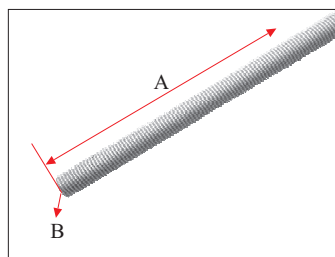

VR-1 5/8"Z ; VR-2 3/4"Z  
VR-3 7/8"Z ; VR-4 1"Z  
VR-16 Z ; VR-20 Z

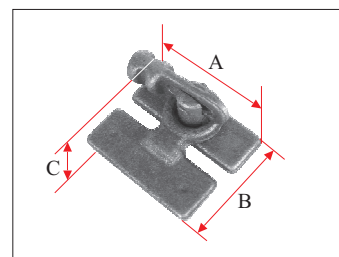

T-5 ; T-5 Z ; T-6 ; T-6 Z

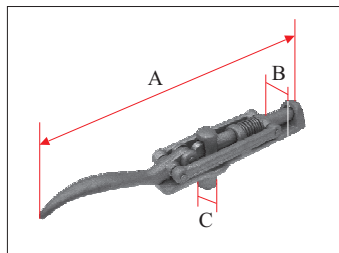

T-8 ; T-9

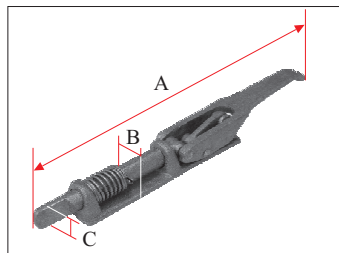

T-10

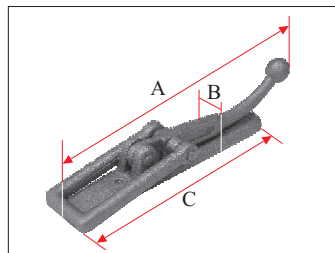

C-2 ; C-2 Z ; C-3 ; C-3 Z  
C-4 ; C-4 Z

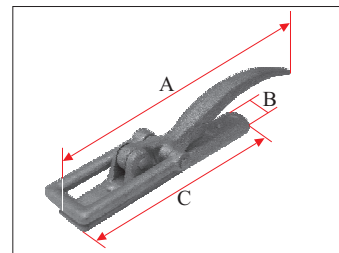

C-12 ; C-12 Z ; C-13  
C-13 Z ; C-14 ; C-14 Z

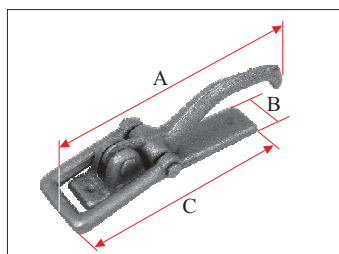

C-5 ; C-5 Z

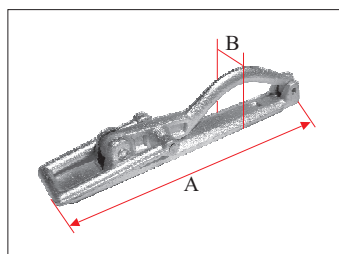

C-7 Z

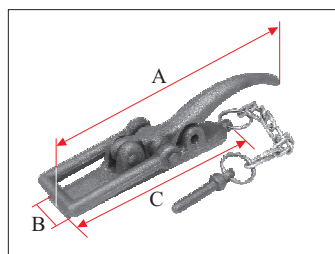

C-8 ; C-8 Z ; C-9 ; C-9 Z

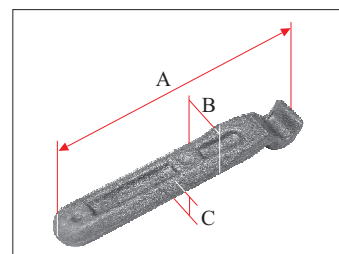

U-2 ; U-2 Z ; U-3 ; U-3 Z  
U-4 ; U-4 Z

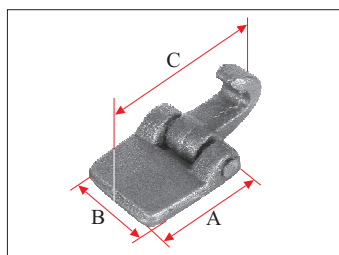

U-6 ; U-6 Z

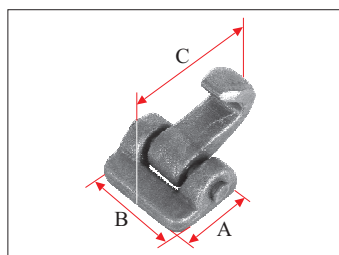

U-7 ; U-7 Z

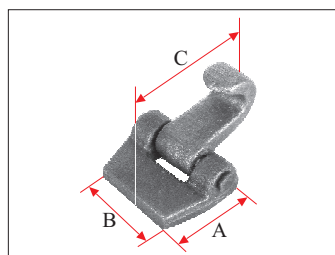

U-8 ; U-8 Z

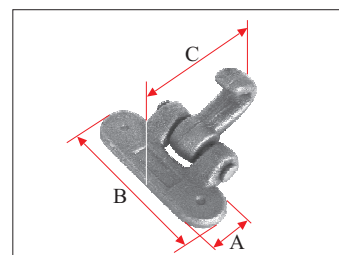

U-9 ; U-9 Z

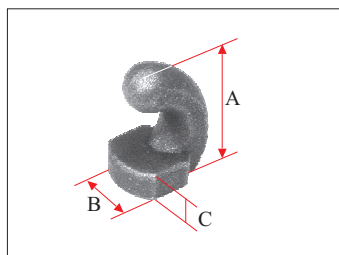

U-30

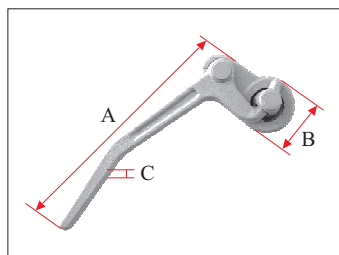

CBL-10 Z ( IZD.)  
CBL-15 Z ( DCH.)

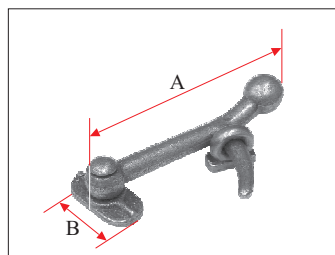

CP-2 ; CP-3

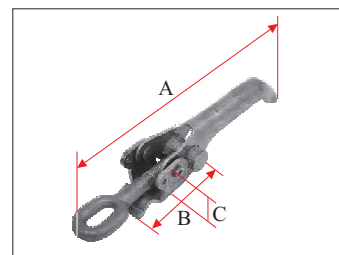

CH-30

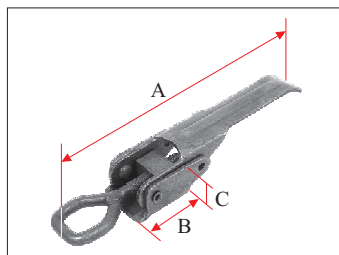

CH-31

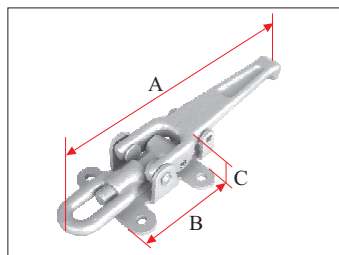

C-15 Z

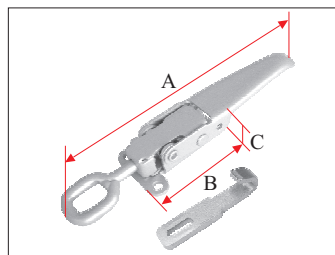

CH-33 Z ; CH-33 INOX

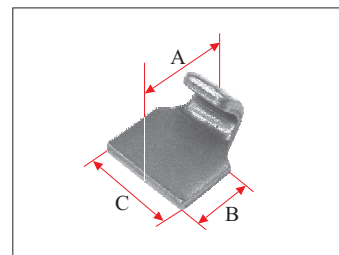

UH-31

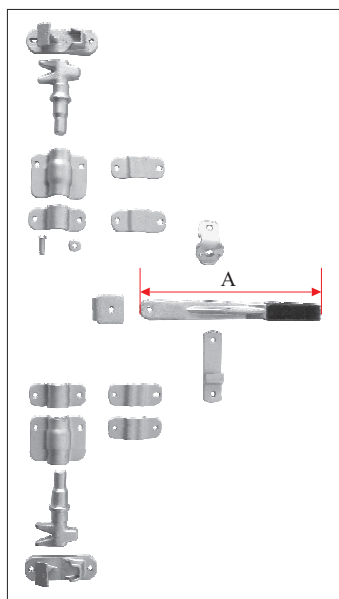

CF-1 Z (completa)  
CF-1.2 Z (sin abrazaderas)  
Para tubo de 27mm

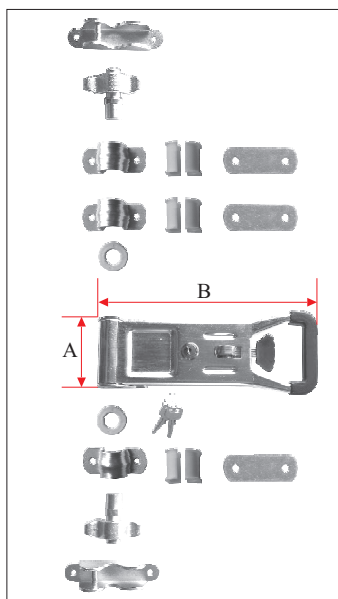

CF-20 Z  
Para tubo de 20mm

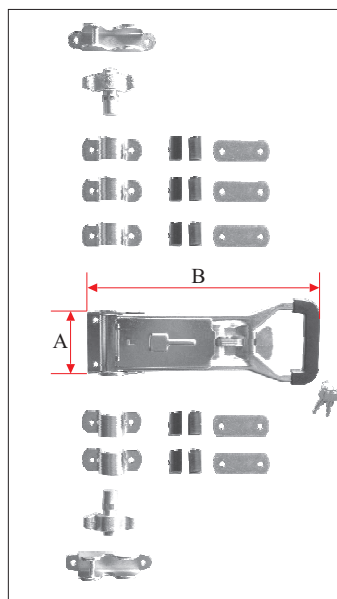

CF-25 Z  
Para tubo de 25mm

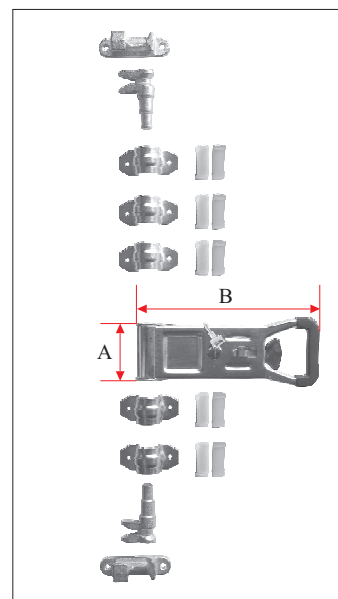

CF-27 Z  
Para tubo de 27mm

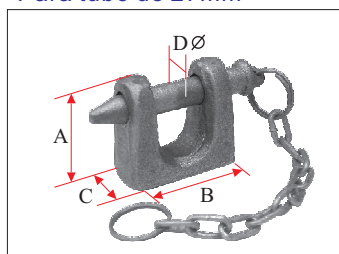

C-11

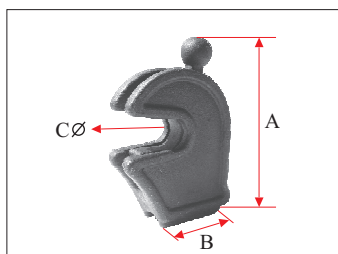

CB-10 ; CB-30

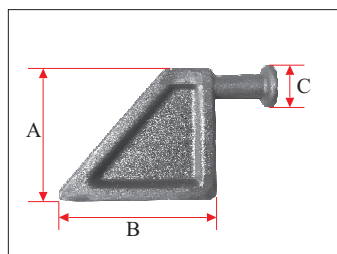

UB-10 ; UB-40

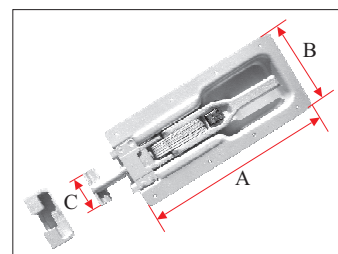

C-16 Z

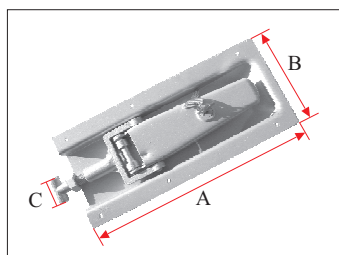

C-17 Z

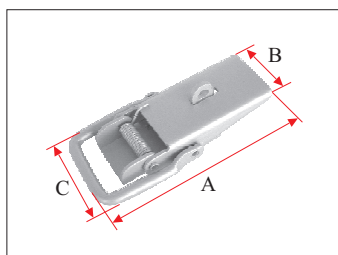

CH-10 Z

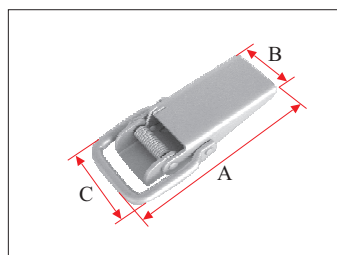

CH-10.2 Z

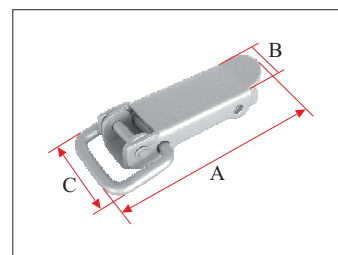

CH-14 Z

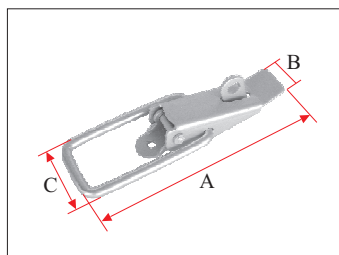

CH-15 Z

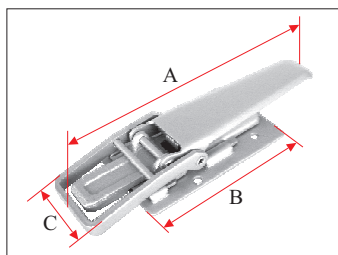

CH-20 Z

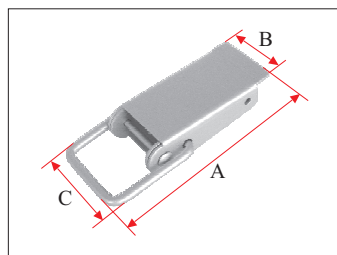

CH-21 Z

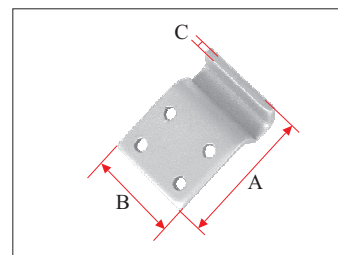

UH-10 Z

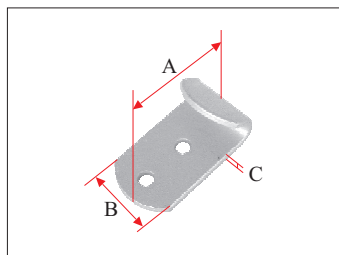

UH-11 Z

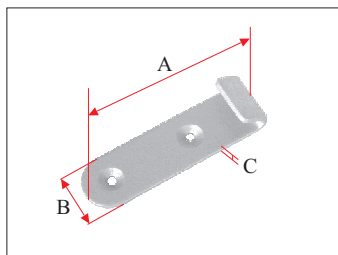

UH-14 Z

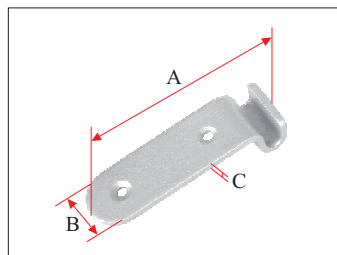

UH-15 Z

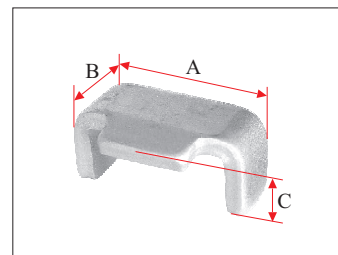

UH-20 Z

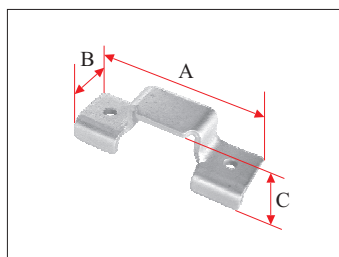

UH-20.2 Z

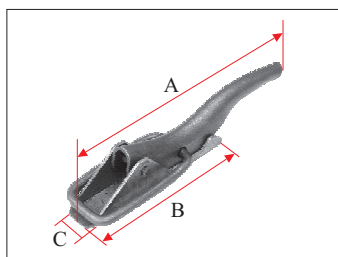

CH-3 ; CH-4

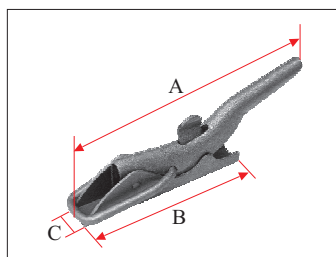

CH-8

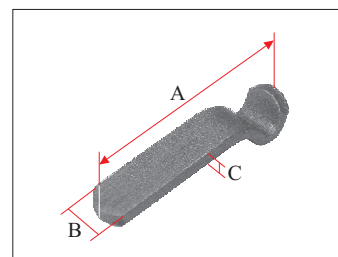

UH 3/8 ; UH-4

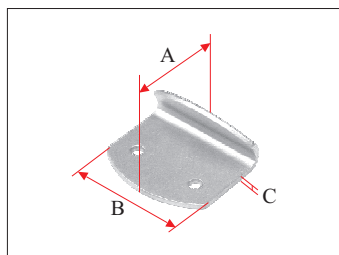

UH-12 Z

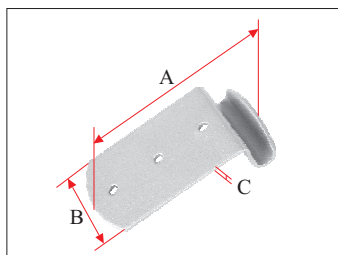

UH-13 Z

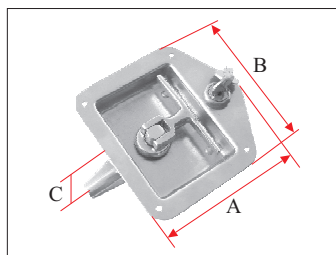

CC-1 Z

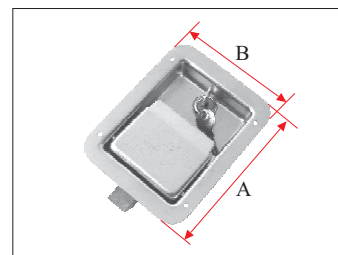

CC-2 Z

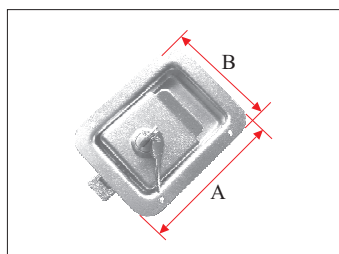

CC-3 Z

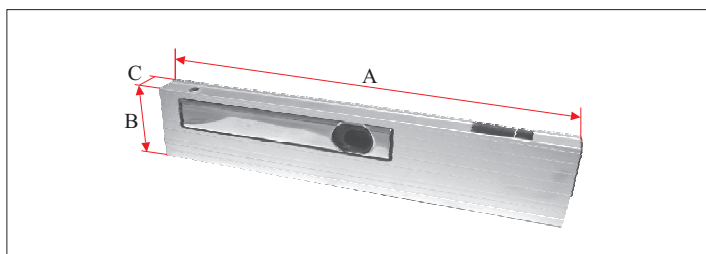

CA-415 I ALU ; CA-415 D ALU ; CA-615 I ALU ; CA-615 D ALU  
CA-815 I ALU ; CA-815 D ALU ; CA-1015 I ALU ; CA-1015 D ALU

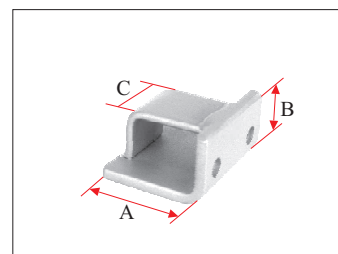

UCA-1 Z

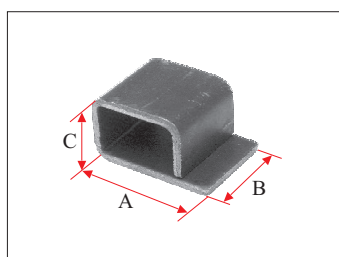

UCA-2

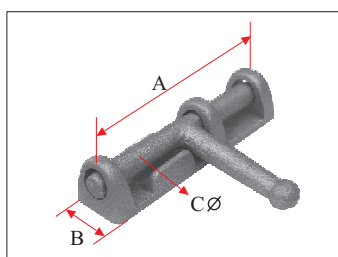

CR-1 ; CR-2

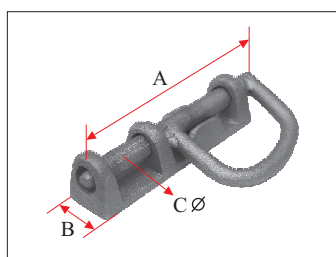

CR-5 ; CR-6

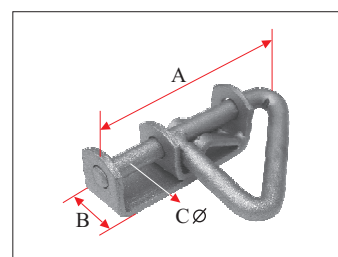

CRH-6

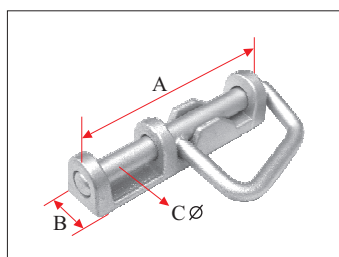

CR-6 ALU

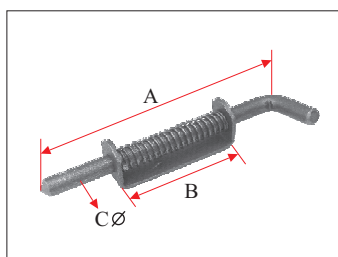

CG-2

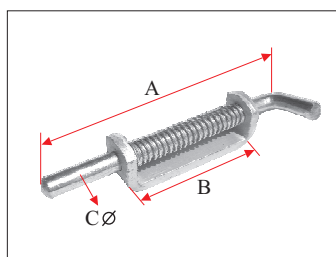

CG-2 ALU

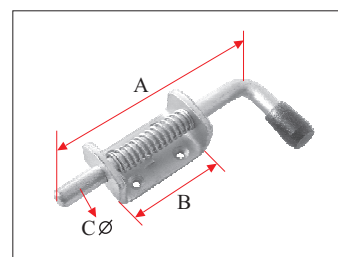

CG-4 Z

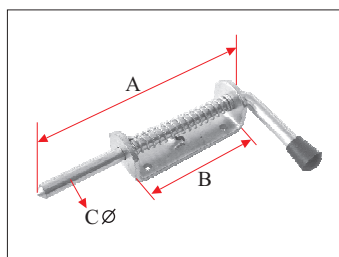

CG-6 Z

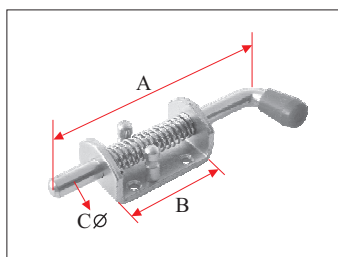

CG-7 Z

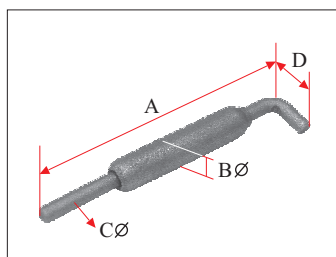

CG-1 ; CG-14

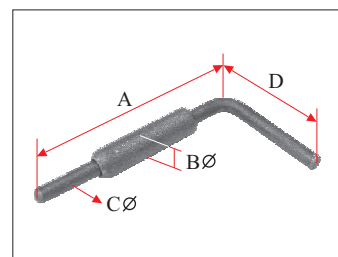

CG-1 L ; CG-14 L



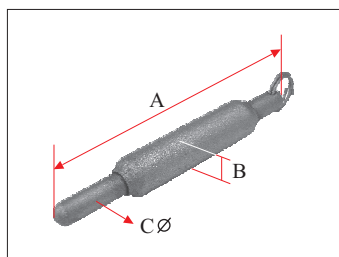

CG-3

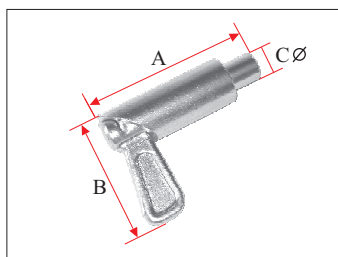

CG-10 Z ; CG-10.2 Z

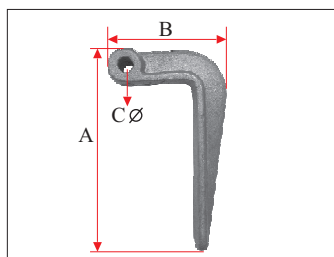

HB-1

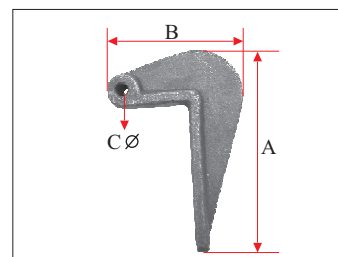

HB-2

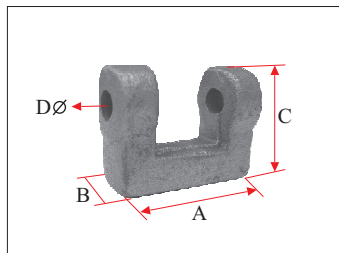

SHB-1

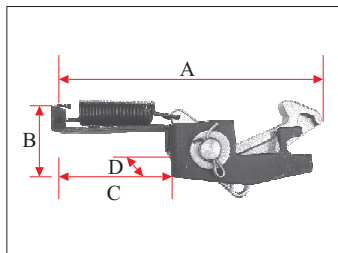

CB-1

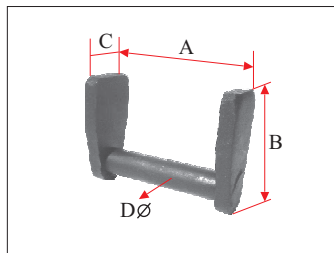

UB-1

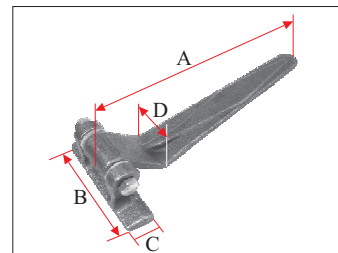

B-1 c/c

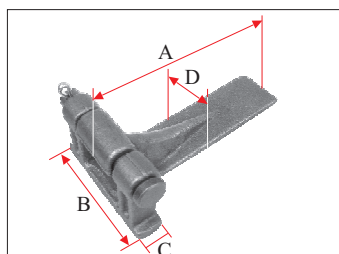

B-4

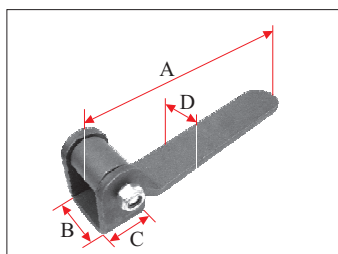

B-10 ; B-11

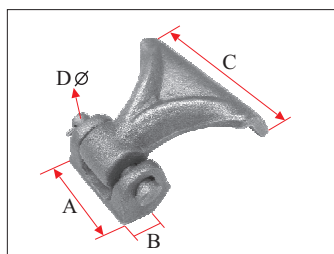

BL-1

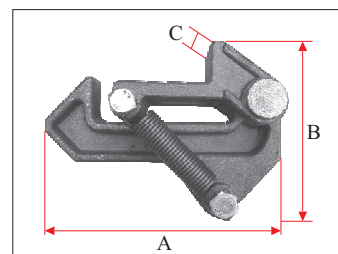

UV-2

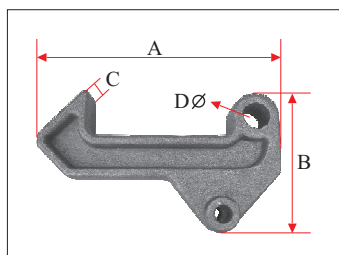

UV-2 S/S

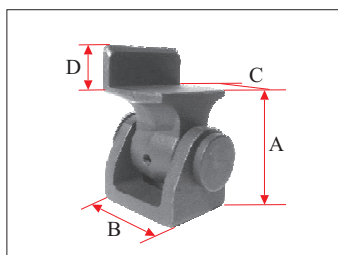

B-15 I ; B-15 D

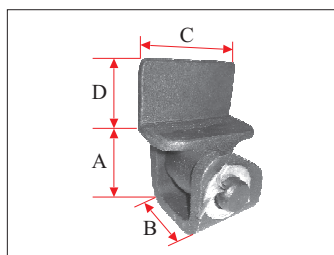

B-16 I ; B-16 D

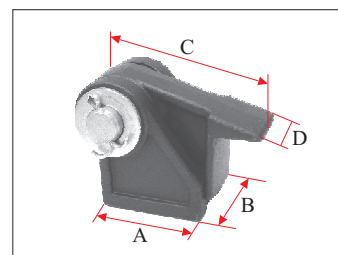

B-20

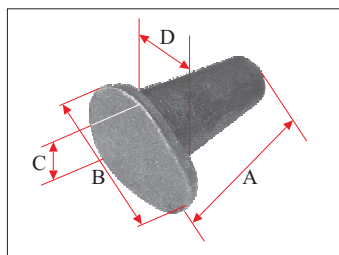

BC-50 ; BC-105 ; BC-115

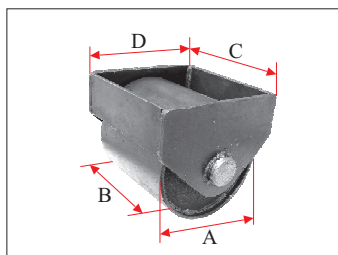

D-160 ; D-200

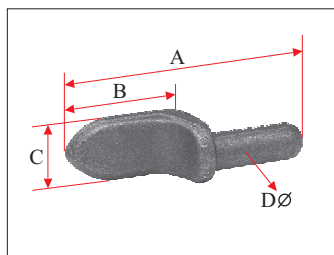

M-1

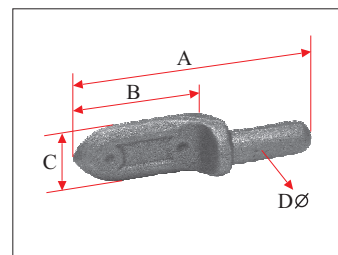

M-2 ; M-3 ; M-4

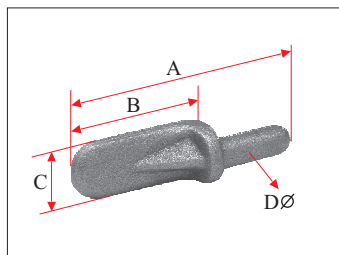

M-5 ; M-6

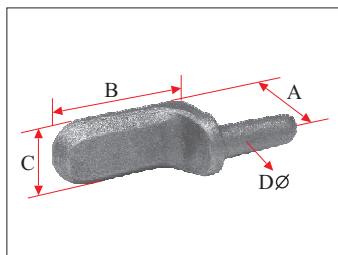

M-8 ; M-8G

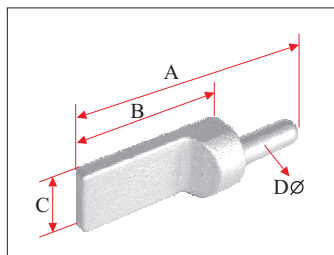

M-40 ; M-41 Z

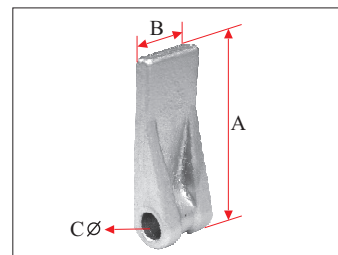

H-40 ; H-41 Z

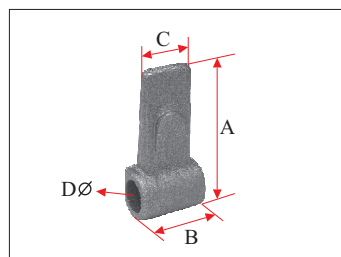

H-1 ; H-2

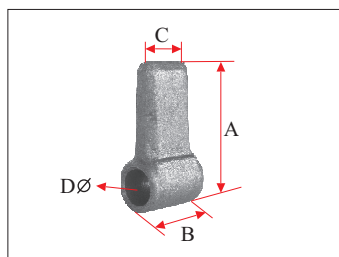

H-3

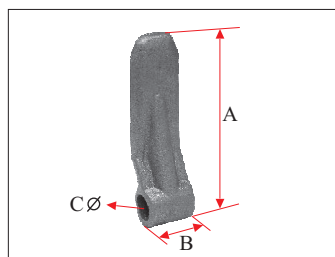

H-5 ; H-10

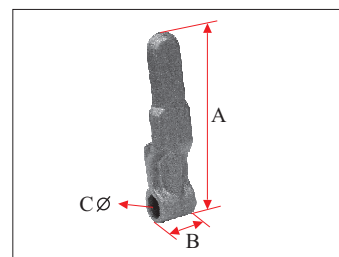

H-15

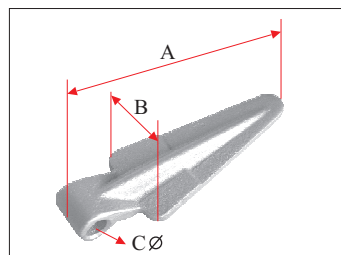

H-16 Z

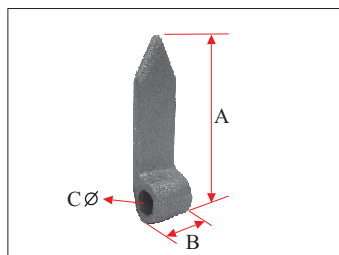

H-6

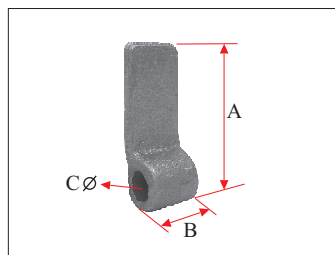

H-7

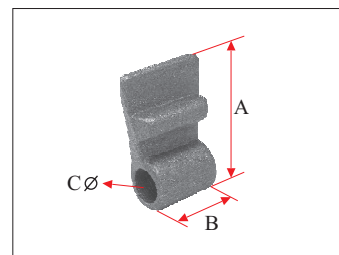

H-13

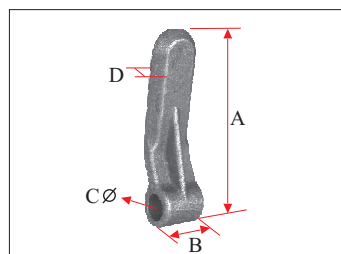

H-5 G

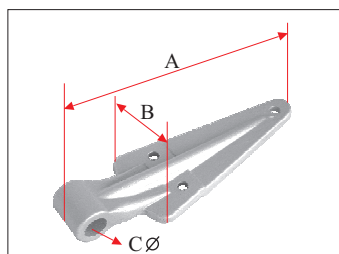

H-16 ALU

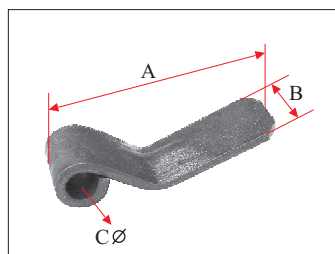

HH-10

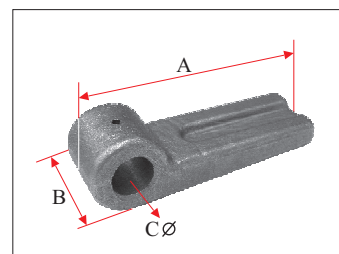

H-18

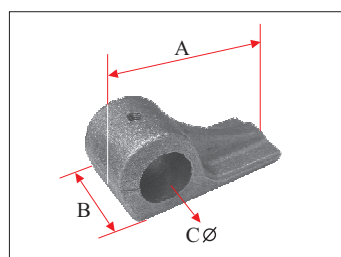

H-20

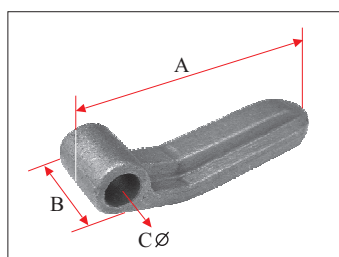

H-28

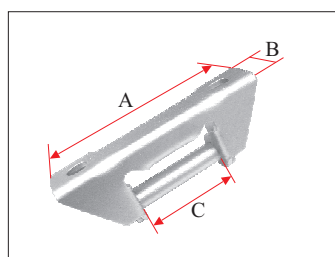

TIR-8 S/S Z

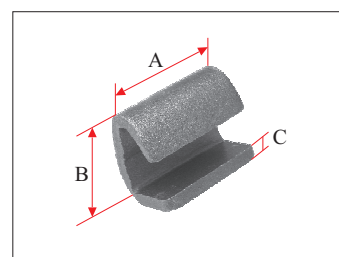

S-1

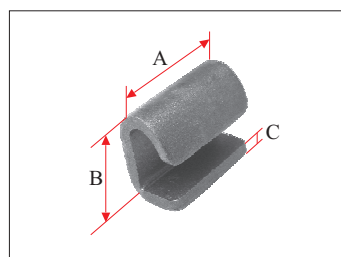

S-2

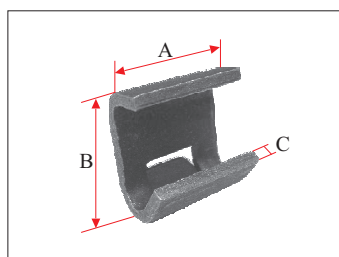

S-3

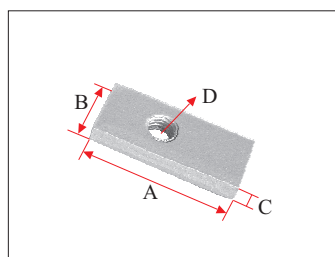

PLT-1 Z

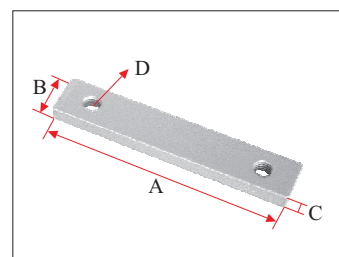

PLT-2 Z

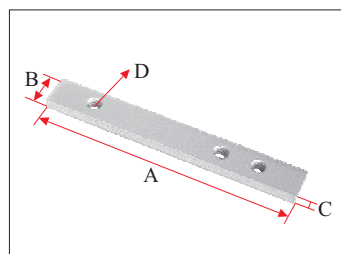

PLT-3 Z

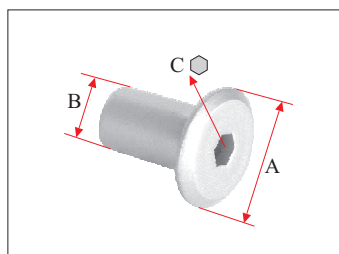

CHAMPIÑON Z

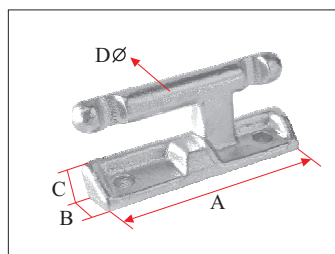

M TIR-7 Z ; M TIR-7 INOX

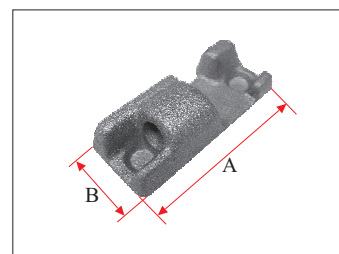

H TIR-7BG ; H TIR-7BD  
H TIR-7 INOX

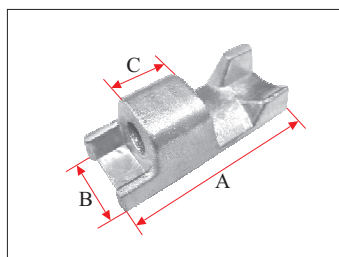

HTIR-7 ALU

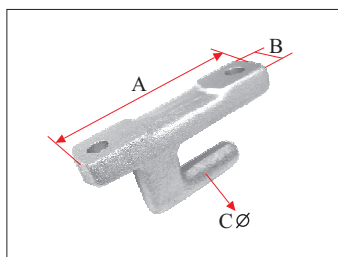

MTIR-9 Z

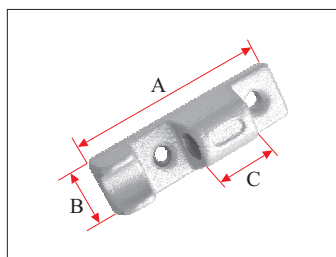

HTIR-9 Z

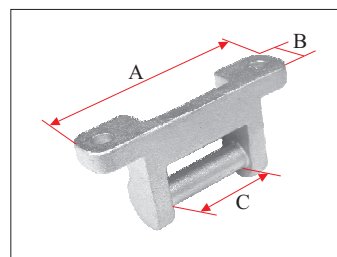

MTIR-11 Z

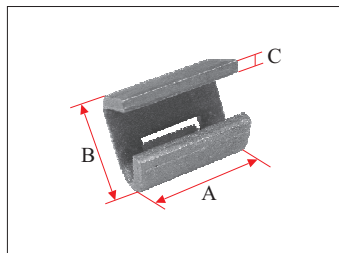

STIR-11

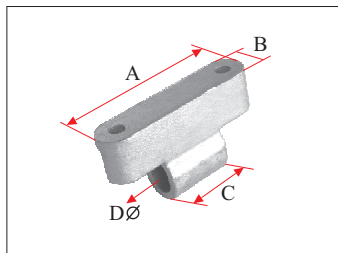

HTIR-14 Z

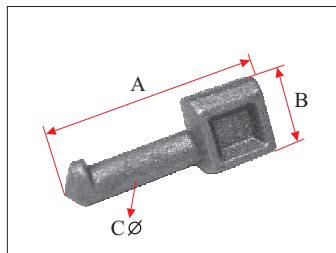

MTIR-14

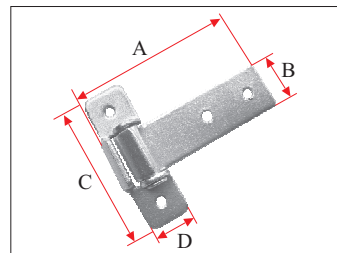

BS-22 Z

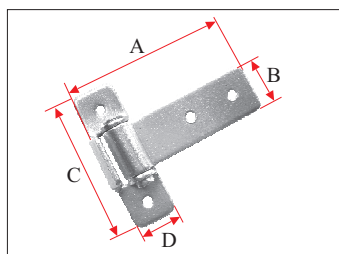

BS-21 Z

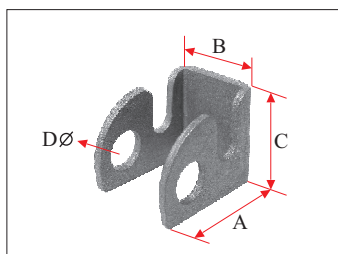

SICT

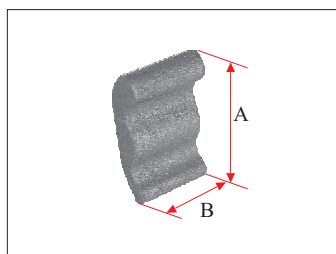

UCT

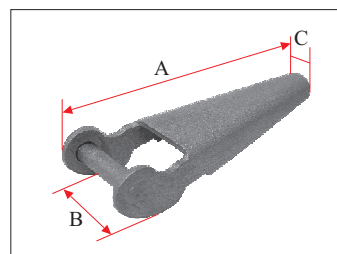

SSCT

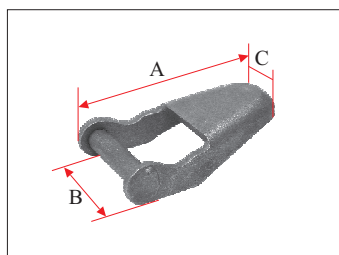

SSCT-C

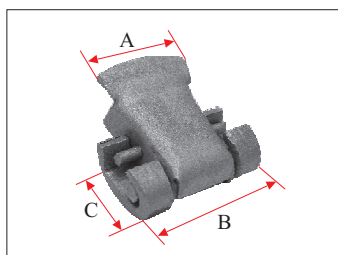

TIR 2 AP

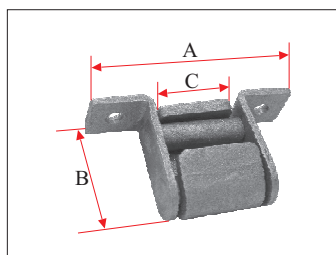

TIRAB

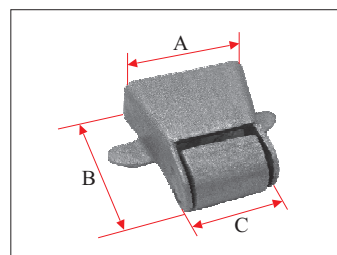

TIR CD

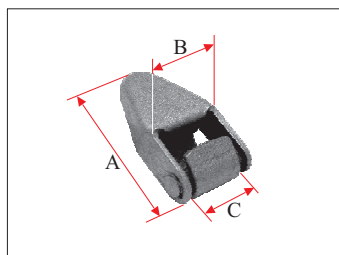

BS-11

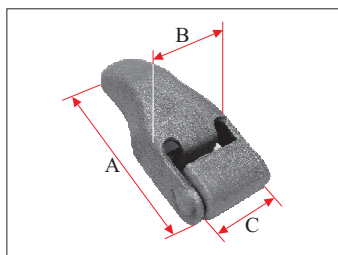

BS-12

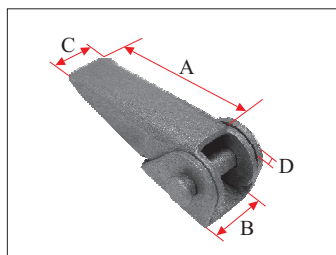

BS-20 ; BS-30 ; BS-40

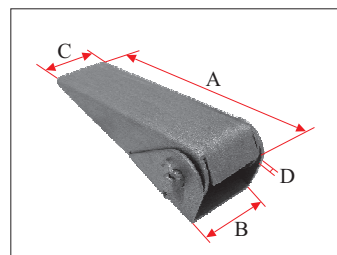

BS-1 ; BS-2 ; BS-3

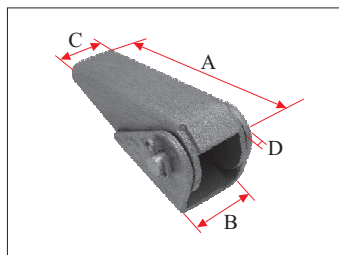

BS-4 ; BS-5

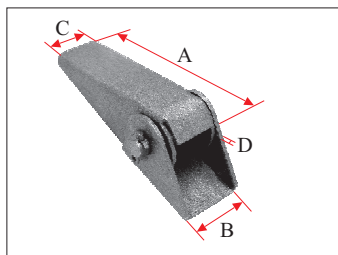

BS-6

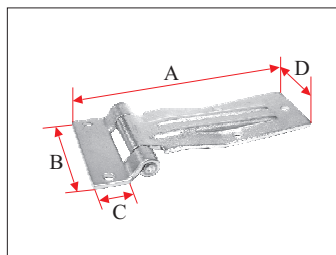

BCS-1 Z ; BCS-1 INOX

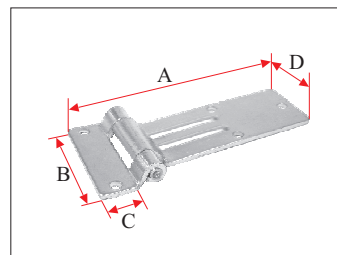

BCS-2 Z ; BCS-2 INOX

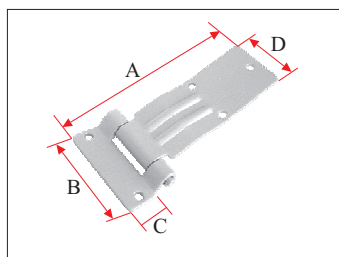

BCS-3 Z ; BCS-3 INOX

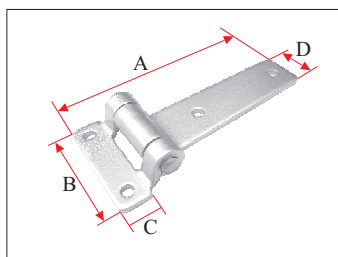

BCS-4 Z

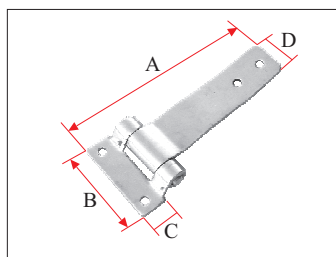

BCS-4 AC Z  
BCS-4 AC INOX

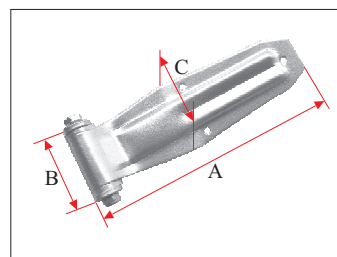

BCS-7 Z

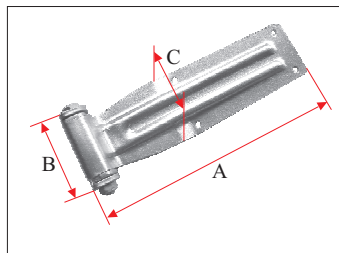

BCS-8 Z

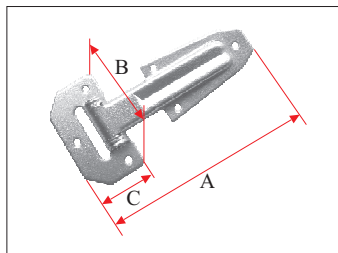

BCS-10 Z

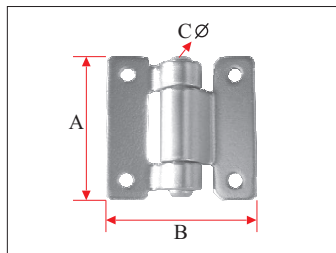

BCS-11 Z

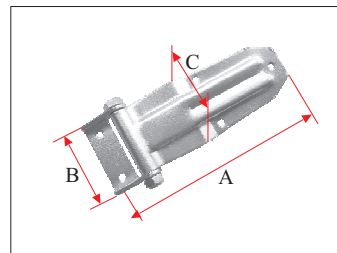

BCS-12 Z

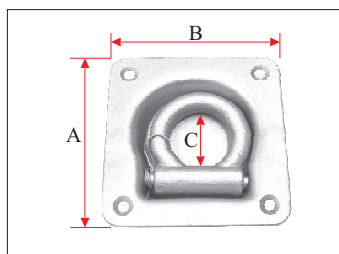

AE-1 Z

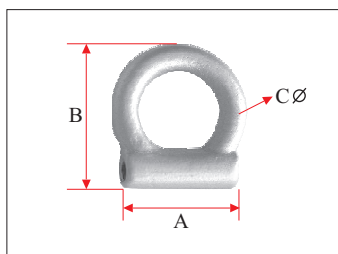

AE-1 S/AZ

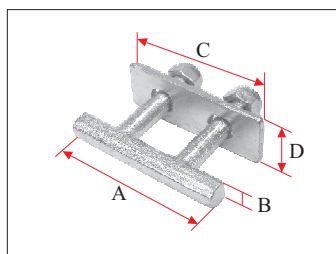

AT-1 Z

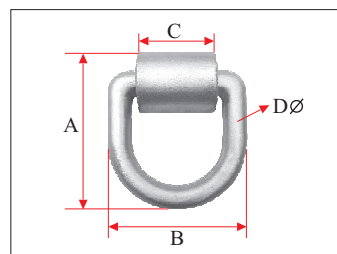

AES-2 Z

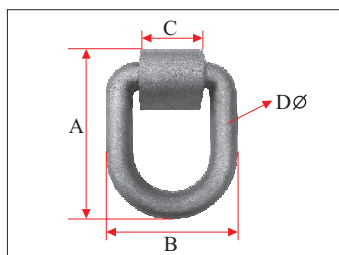

AES-1

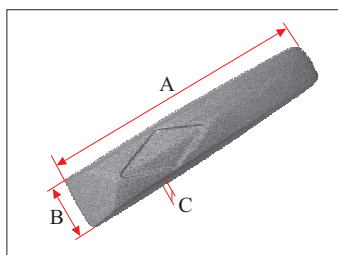

P-0 ; P-1 ; P-2 ; P-3

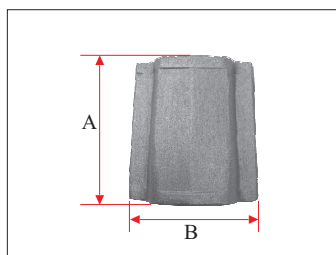

AP-0 ; AP-1 ; AP-2 ; AP-3

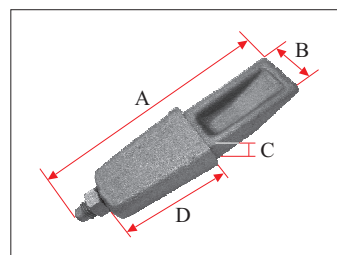

CU-1 70x30 ; CU-2 70x25  
CU-3 90x30 ; CU-4 110x30

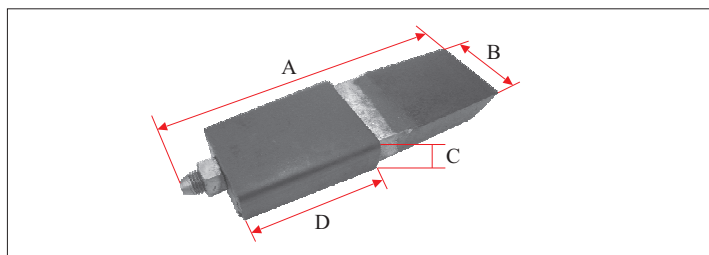

CLL-1 60x25 ; CLL-2 70x25 ; CLL-3 90x25L ; CLL-4 90x25  
CLL-5 110x25 ; CLL-6 70x30 ; CLL-7 90x30 ; CLL-8 110x30

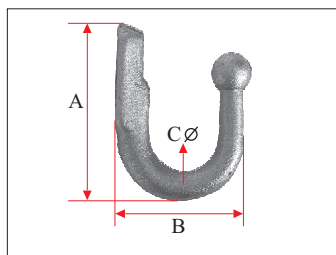

G-1

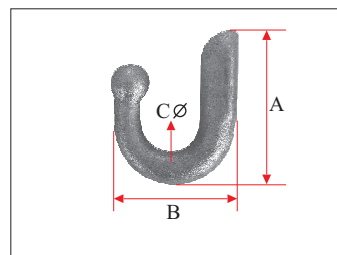

G-2 ; G-2 ALU

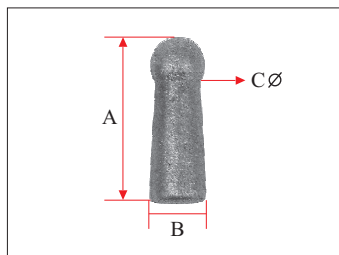

G-3

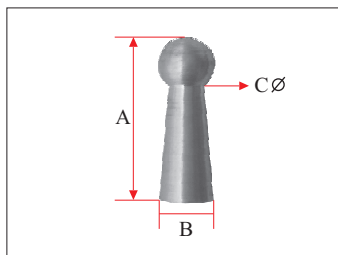

G-3 MALU

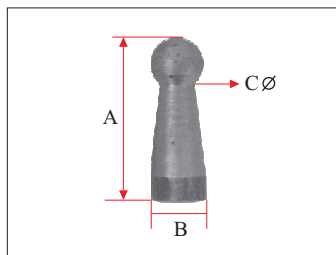

G-3M

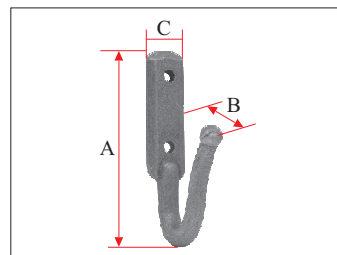

G-4 ; G-5



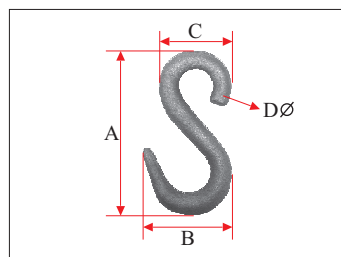

G-6 ; G-7 ; G-10

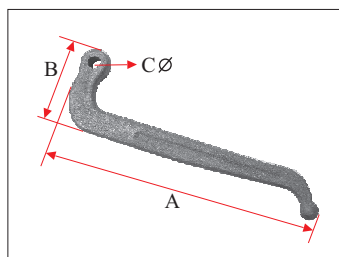

G-9

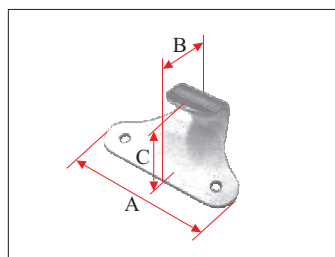

GH-2 Z

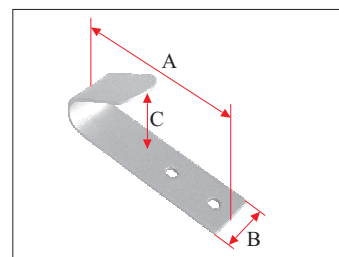

GH-4 Z ; GH-5 Z

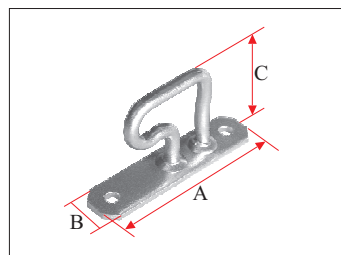

GH-11 Z

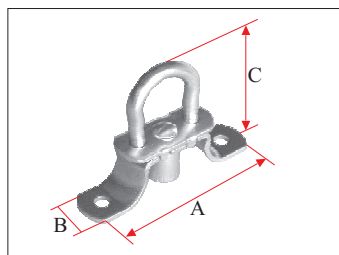

GH-12 Z

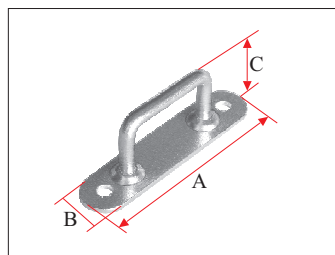

GH-13 Z

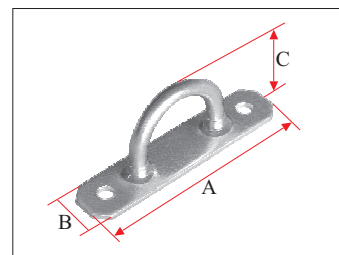

GH-14 Z

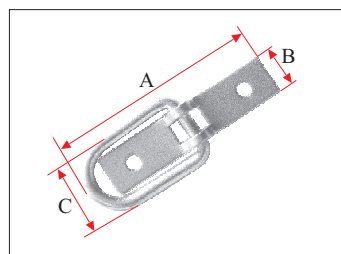

GH-15 Z

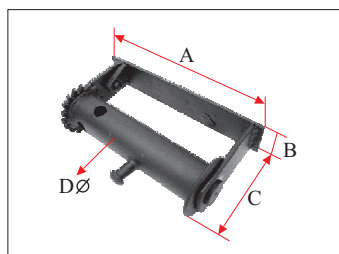

T/T-40 S/C

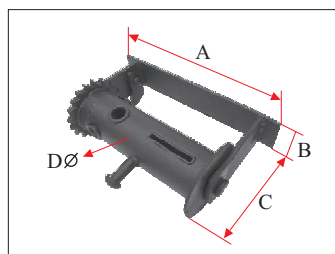

TT-60 C/CE

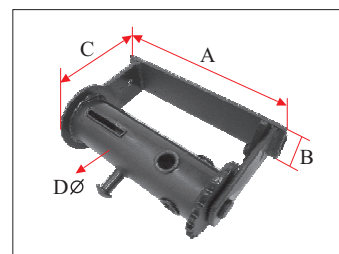

TT-60 C/C DES

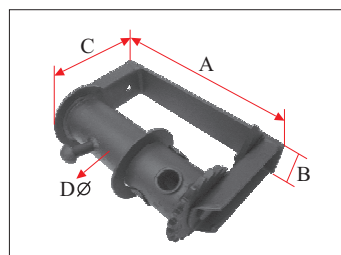

TT-60 C/C

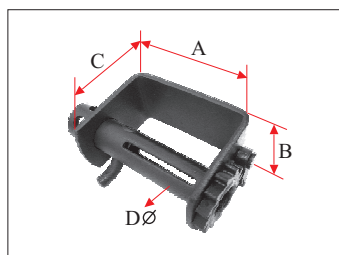

TT-48 R/F

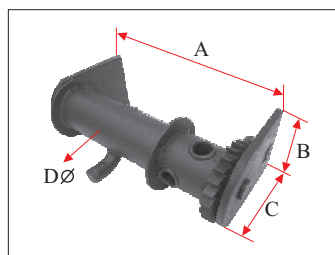

TT-60 RF

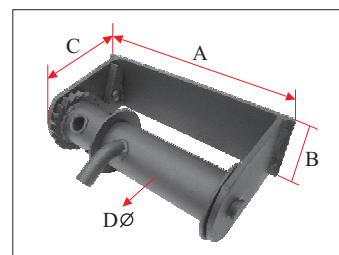

TT-60 RF/B

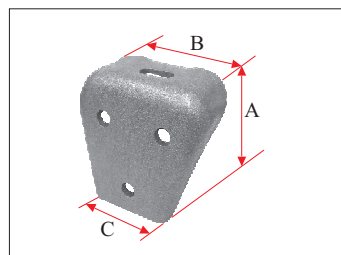

SC-1

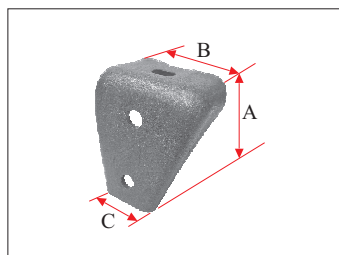

SC-2

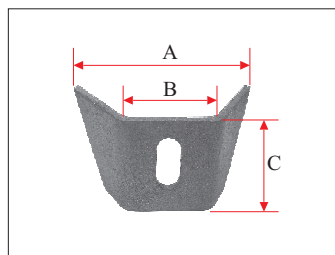

SC-3

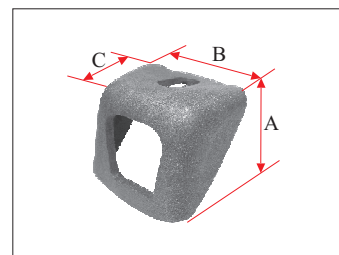

SC-4

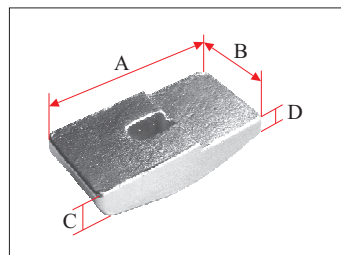

SC-6 Z

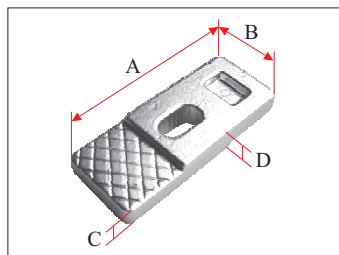

SC-7 Z

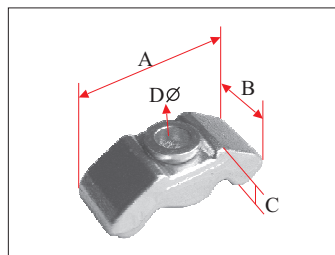

SC-10 Z ; SC-11 Z

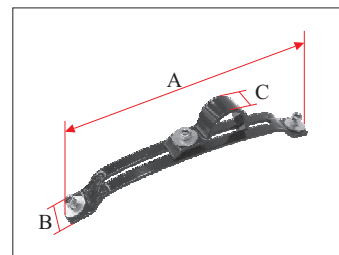

SRA-1

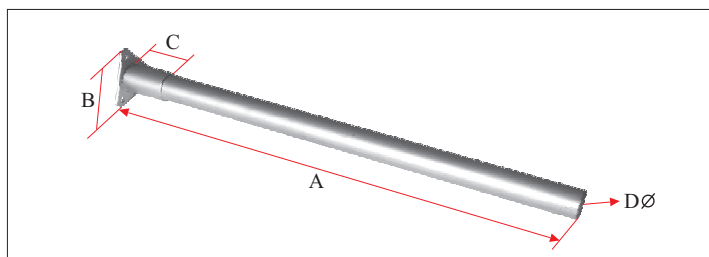

SRA-3 Z

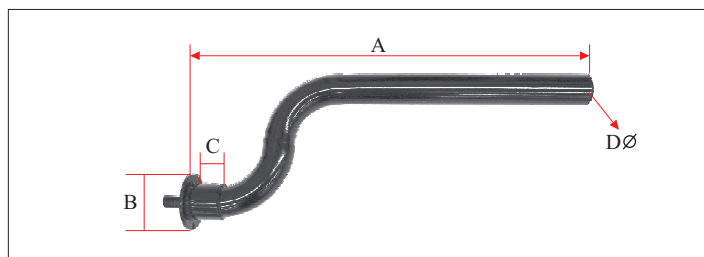

SRA-5

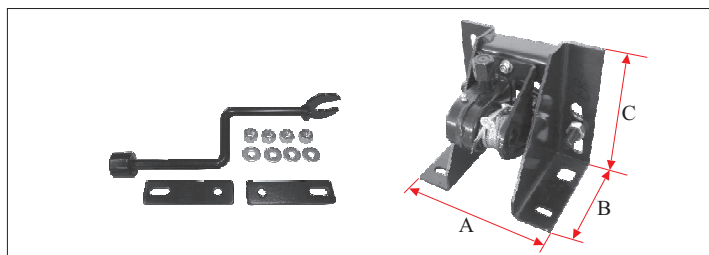

ER-1

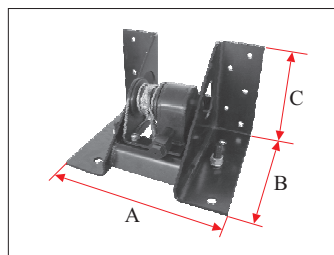

ER-2

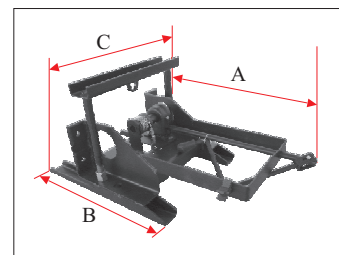

ER-3.2

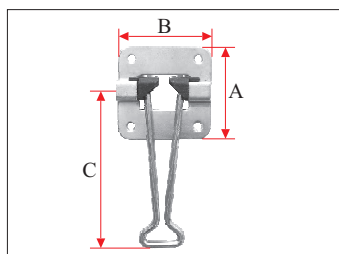

RPM-1 Z

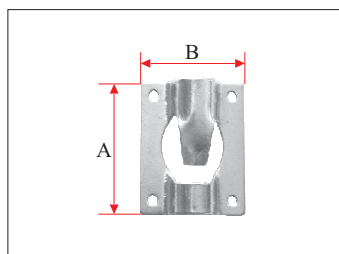

RPH-1 Z

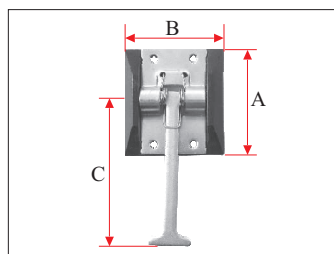

RPM-2 Z ; RPM-2 INOX

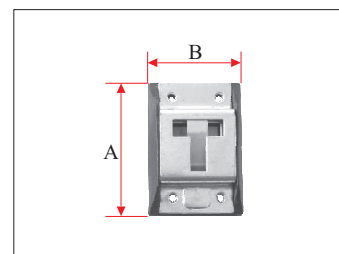

RPH-2 Z ; RPH-2 INOX

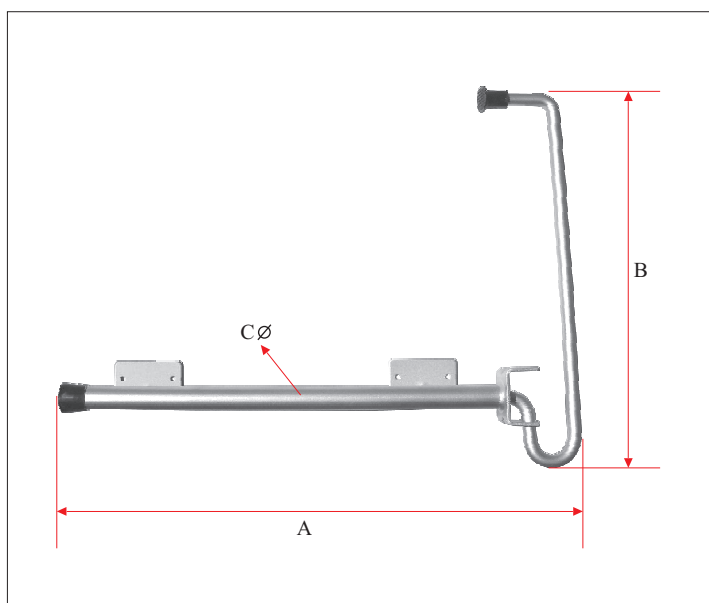

RP-10 Z

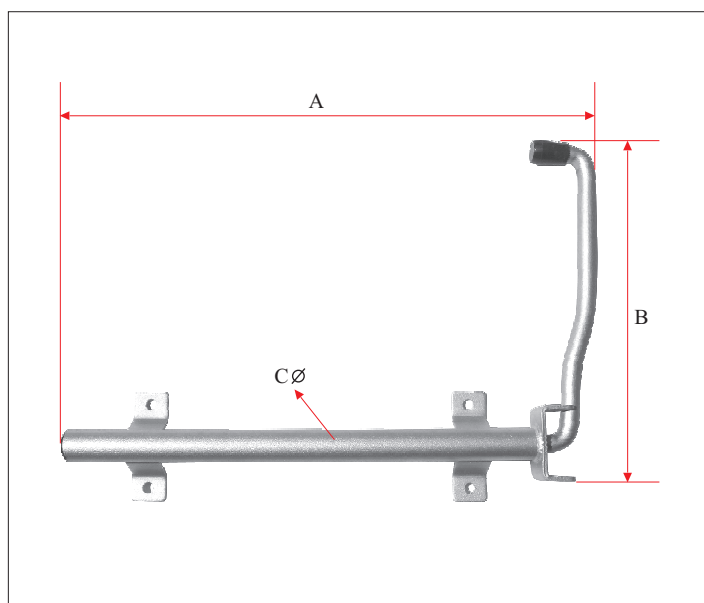

RP-11 Z

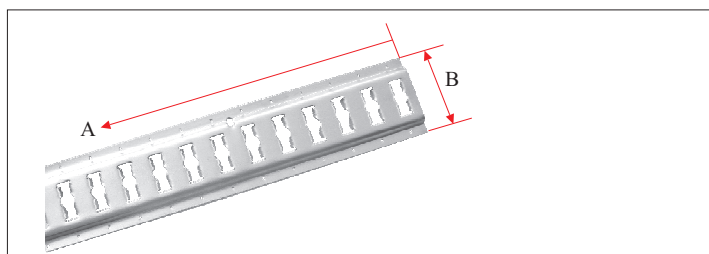

TSC-10 Z

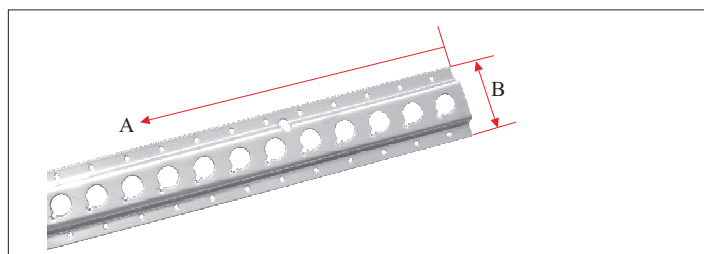

TSC-11 Z

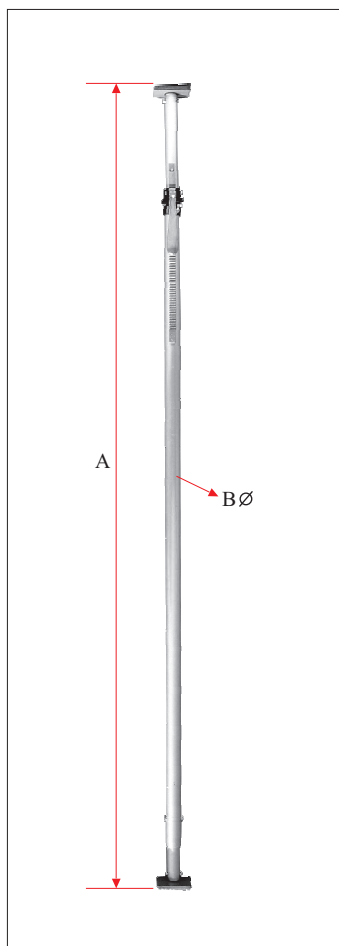

TSC-2 Z

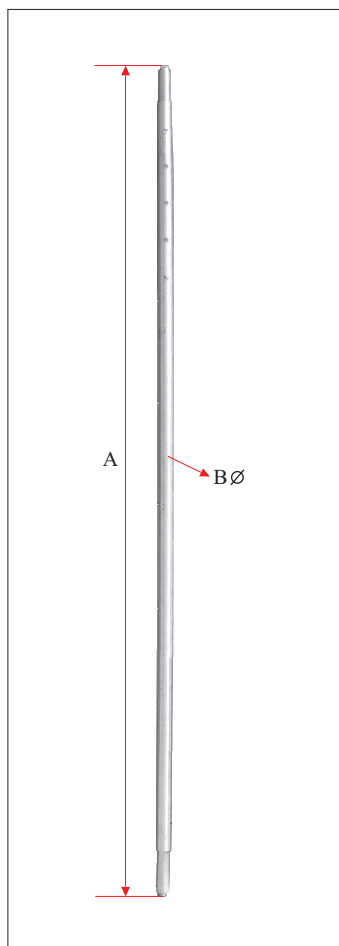

TSC-3 Z

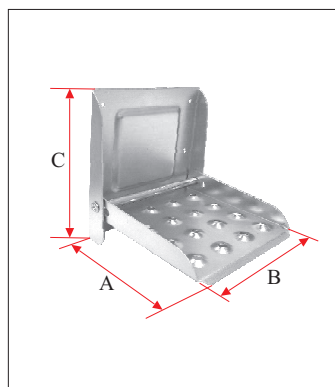

ESC-0 Z

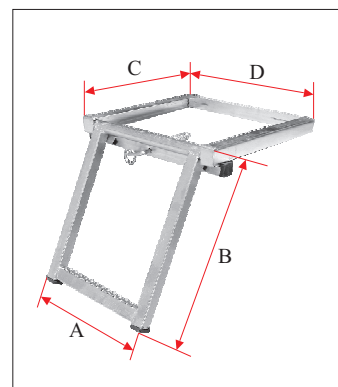

ESC-1 Z

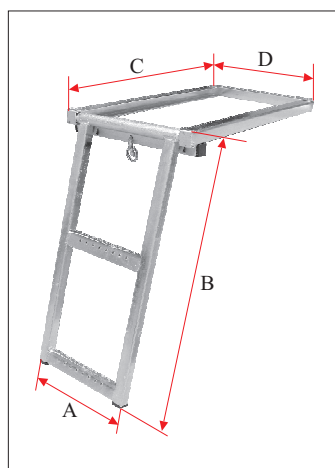

ESC-2 Z

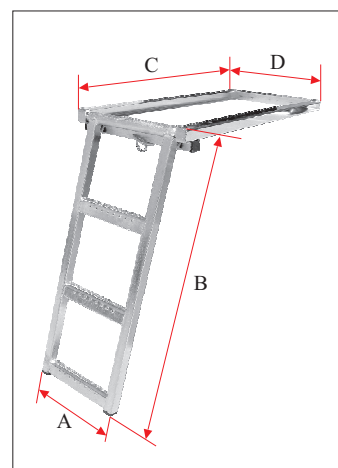

ESC-3 Z

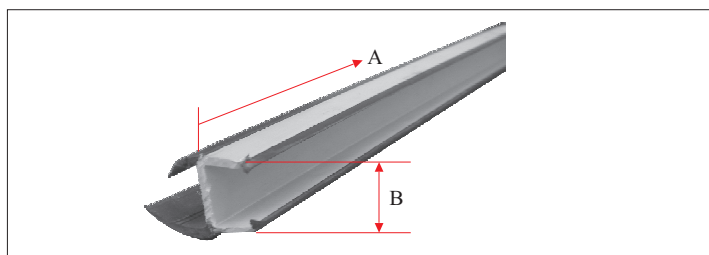

PERFIL-1 20x500 ; PERFIL-2 20x400 ; PERFIL-3 30x500  
PERFIL-4 30x400 ; PERFIL-5 25x500

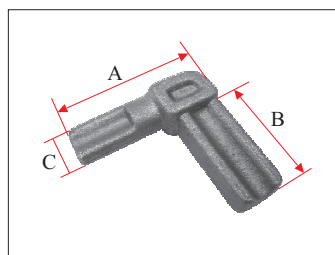

EA-2

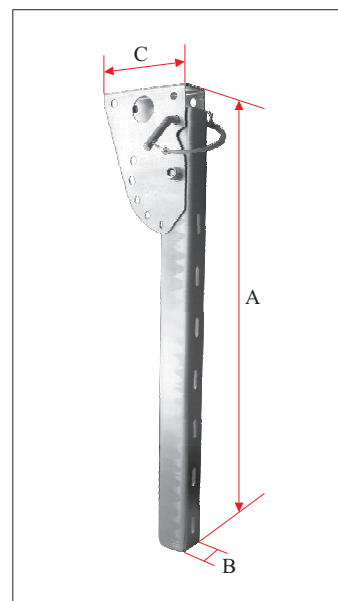

PLAC-1 Z

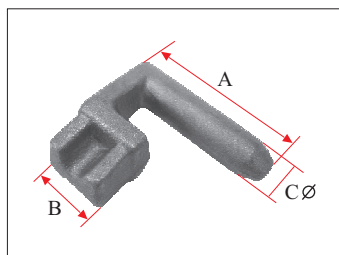

EA-3

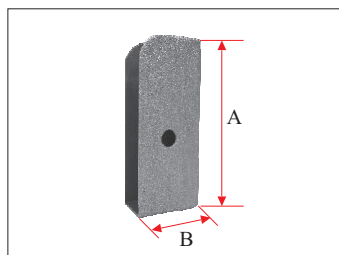

CJ-1 Z ; CJ-15

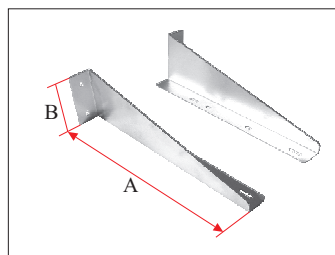

SBD-1 Z

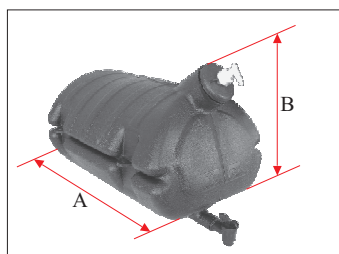

BD-1

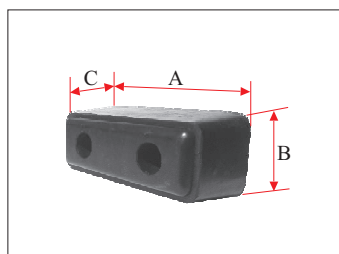

TG-0 ; TG-1 ; TG-2 ; TG-3

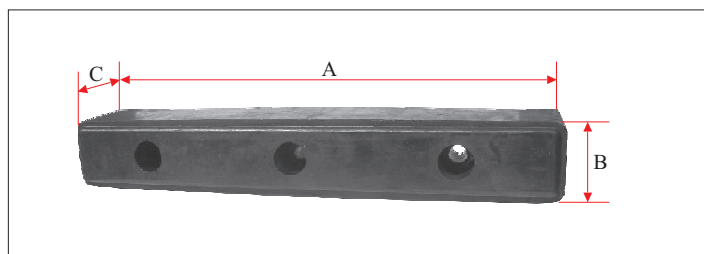

TG-4

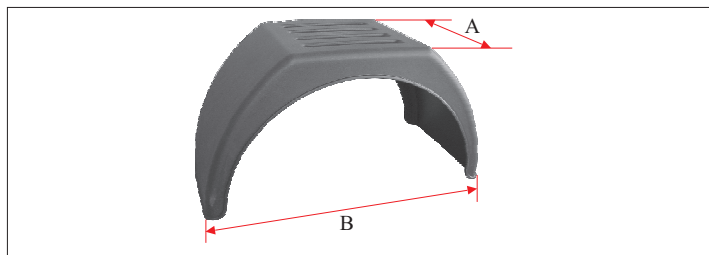

GBP-1 450x880

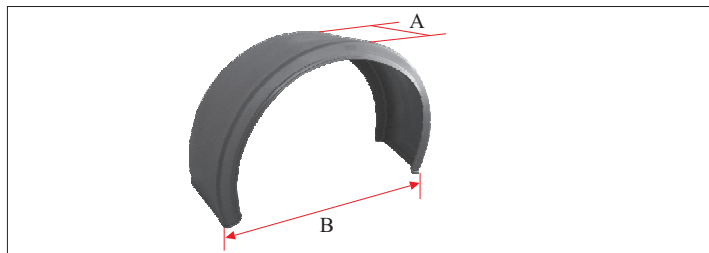

GB-1 410x860 ; GB-2 450x860 ; GB-3 500x1000  
GB-4 550x1100 ; GB-5 435x1300 ; GB-6 670x1340

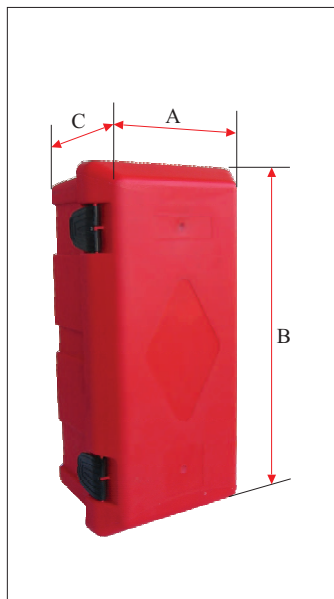

CAJA EX-1 (6/9 kg)



CAJA EX-2 (6 kg)  
CAJA EX-3 (9 kg)

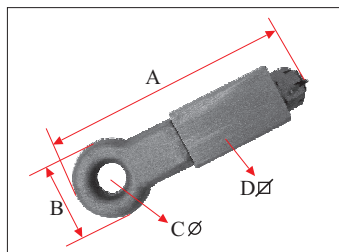

TLH-50 ; TLH-60  
TLH-70 ; TLH-80

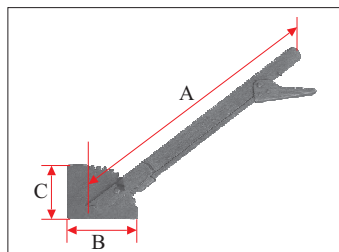

PLF-1

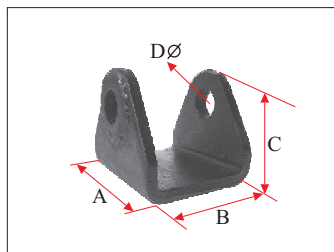

SBO-1

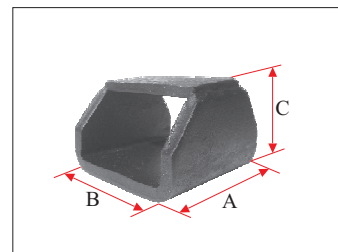

SBR-1

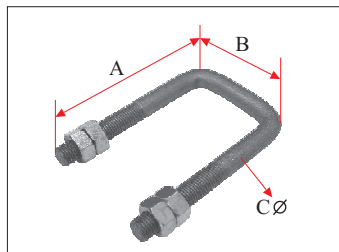

AB-1 16x140 ; AB-2 18x140  
AB-3 18x160

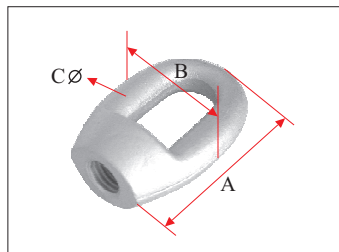

AR-1 M20 Z

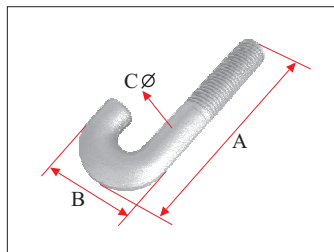

GR-1 M20 Z

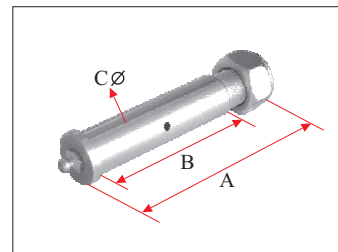

BB-1 22,5x85 Z  
BB-2 25x105 Z

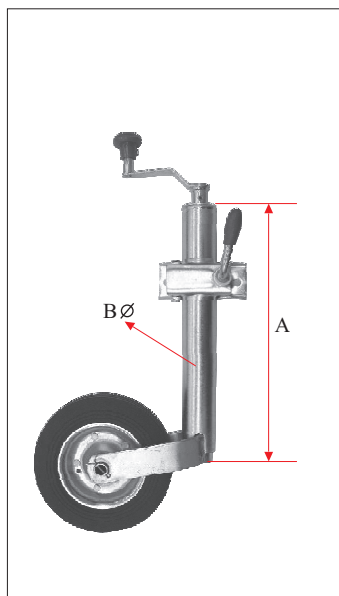

RJ-48

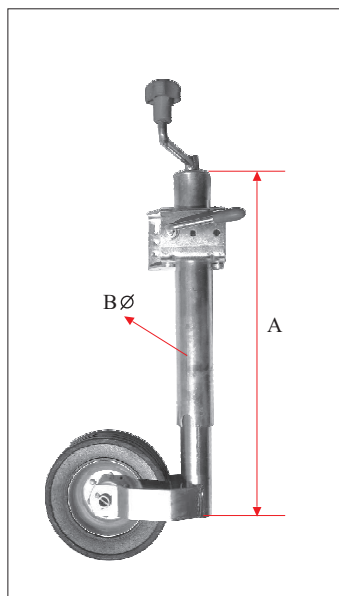

RJ-60

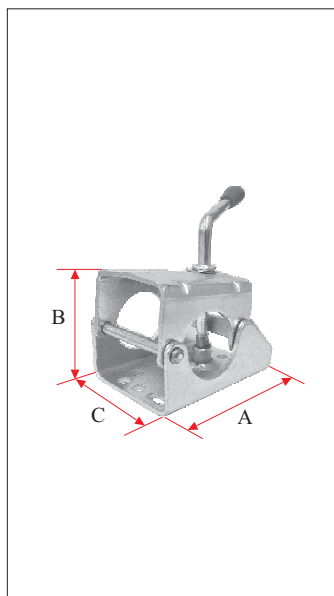

ABRJ-48 ; ABRJ-60

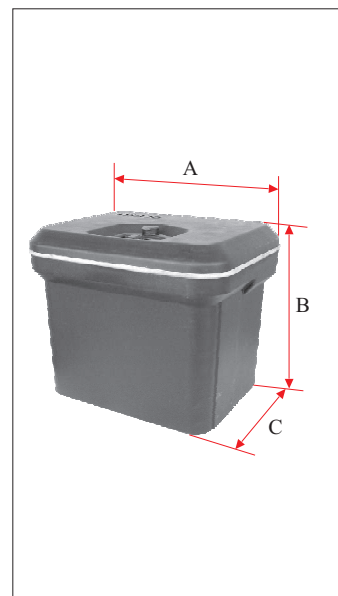

CAJA DE HERRAMIENTAS  
Ancho : 410 ; 500 ; 600 ; 800





NOMBRE	A (mm)	B (mm)	C (mm)	D (mm)
AB-1 16x140	160	105	16	
AB-2 18x140	160	105	18	
AB-3 18x160	180	105	18	
ABRJ-48	130	60	53	
ABRJ-60	130	100	100	
AE-1 S/A ZINC	48	45	12	
AE-1 ZINC	102	95	33	
AES-1	172	128	61	26
AES-2 ZINC	130	115	65	19
AP-0	129	110		
AP-1	115	105		
AP-2	96	84		
AP-3	85	77		
AR-1 M20 ZINC	99	67	18	
AT-1 ZINC	95	14	90	30
B-1 c/c	275	120	28	45
B-10	307	74	50	50
B-11	222	69	35	50
B-15 D	79	64	53	32
B-15 I	79	64	53	32
B-16 D	100	92	109	66
B-16 I	100	92	109	66
B-20	90	68	154	50
B-4	225	143	27	60
BB-1 22,5 x 85 ZINC	120	90	22	
BB-2 25 x 105 ZINC	140	105	24	
BC-105	117	83	68	52
BC-115	127	83	68	52
BC-50	60	83	68	52
BCS-1 INOX	185	85	25	55
BCS-1 ZINC	185	85	25	55
BCS-10 ZINC	140	70	40	
BCS-11 ZINC	60	59	16	
BCS-12 ZINC	220	77	70	
BCS-2 INOX	180	85	25	55
BCS-2 ZINC	180	85	25	55
BCS-3 INOX	180	85	25	55
BCS-3 ZINC	180	85	25	55
BCS-4 AC INOX	138,5	60	19	27
BCS-4 AC ZINC	138,5	60	19	27
BCS-4 ZINC	135	60	16	26
BCS-7 ZINC	275	82	83	
BCS-8 ZINC	290	88	82	
BD-1	450	340		
BL-1	70	40	90	12
BS-1	165	60	50	3

NOMBRE	A (mm)	B (mm)	C (mm)	D (mm)
BS-11	84	44	28	
BS-12	130	54	40	
BS-2	165	60	50	4
BS-20	80	28	20	3
BS-21 ZINC	100	28	85	25
BS-22 ZINC	100	28	85	25
BS-3	155	37	28	3
BS-30	107	40	30	4
BS-4	126	45	38	3
BS-40	141	49	40	4
BS-5	126	48	38	4
BS-6	126	45	38	3
C-11	51	56	25	12
C-12	260	31	199	
C-12 ZINC	260	31	199	
C-13	195	26	144	
C-13 ZINC	195	26	144	
C-14	163	22	114	
C-14 ZINC	163	22	114	
C-15 ZINC	260	106	35	
C-16 ZINC	270	120	53	
C-17 ZINC	275	120	32	
C-2	245	33	195	
C-2 ZINC	245	33	195	
C-3	193	26	146	
C-3 ZINC	193	26	146	
C-4	155	22	114	
C-4 ZINC	155	22	114	
C-5	135	21	114	
C-5 ZINC	135	21	114	
C-7	312	34		
C-7 ZINC	312	34		
C-8	260	33	183	
C-8 ZINC	260	33	183	
C-9	197	26	147	
C-9 ZINC	197	26	147	
CA-1015 D ALU	1015	78	25	
CA-1015 I ALU	1015	78	25	
CA-415 D ALU	415	78	25	
CA-415 I ALU	415	78	25	
CA-615 D ALU	615	78	25	
CA-615 I ALU	615	78	25	
CA-815 D ALU	815	78	25	
CA-815 I ALU	815	78	25	
CAJA EX-1	310	610	250	
CAJA EX-2	310	675	250	



NOMBRE	A (mm)	B (mm)	C (mm)	D (mm)
CAJA EX-3	310	675	250	
CAJA HERRA.410	410	330	340	
CAJA HERRA.500	500	350	400	
CAJA HERRA.600	600	400	500	
CAJA HERRA.800	800	500	500	
CB-1	270	75	118	51
CB-10	136	67	23	
CB-30	135	75	33	
CBL-10 ZINC	263	60	12	
CBL-15 ZINC	263	60	12	
CC-1 ZINC	124	121	25	
CC-2 ZINC	140	108		
CC-3 ZINC	120	92		
CF-1 ZINC	343			
CF-1.2 ZINC s/abra.	343			
CF-20 ZINC	90	260		
CF-25 ZINC	85	320		
CF-27 ZINC	85	280		
CG-1	174	20	10	35
CG-1 L	165	20	10	90
CG-10 ZINC	71	49	12	
CG-10.2 ZINC	71	49	14	
CG-14	222	25	14	53
CG-14 L	190	25	14	103
CG-2	218	110	14	
CG-2 ALU	210	115	14	
CG-3	185	25	14	
CG-4 ZINC	162	75	12	
CG-6 ZINC	230	120	12	
CG-7 ZINC	165	73	12	
CH-10 ZINC	144	48	68	
CH-10.2 ZINC	140	48	68	
CH-14 ZINC	89	24	39	
CH-15 ZINC	120	20	40	
CH-20 ZINC	260	143	63	
CH-21 ZINC	115	40	53	
CH-3	213	130	27	
CH-30	275	83	40	
CH-31	200	40	25	
CH-33 INOX	240	82	30	
CH-33 ZINC	240	82	30	
CH-4	160	104	24	
CH-8	280	183	30	
CHAMPIÑON ZINC	24	12.5	6	
CJ-1 ZINC	130	50		
CJ-15	130	50		

NOMBRE	A (mm)	B (mm)	C (mm)	D (mm)
CLL-1 60x25	310	60	25	120
CLL-2 70x25	360	70	25	130
CLL-3 90x25 L	370	90	25	160
CLL-4 90x25	340	90	25	130
CLL-5 110x25	360	110	25	160
CLL-6 70x30	330	70	30	140
CLL-7 90x30	335	90	30	130
CLL-8 110x30	365	110	30	160
CP-2	173	60		
CP-3	145	50		
CR-1	170	40	19	
CR-2	150	35	16	
CR-5	200	40	19	
CR-6	170	35	17	
CR-6 ALU	155	34	17	
CRH-6	165	39	16	
CU-1 70x30	300	70	30	135
CU-2 70x25	300	70	25	130
CU-3 90x30	325	90	30	160
CU-4 110x30	380	110	30	180
D 160	160	160	190	180
D 200	200	180	235	230
EA-2	80	47	27	
EA-3	80	31	19	
ER-1	208	145	190	
ER-2	330	255	220	
ER-3.2	770	490	392	
ESC-0 ZINC	187	170	188	
ESC-1 ZINC	290	365	350	360
ESC-2 ZINC	270	625	650	350
ESC-3 ZINC	270	730	750	350
G-1	80	60	13	
G-10	81	42	37	10
G-2	57	47	13	
G-2 ALU	55	54	12	
G-3	37	13	10	
G-3M	32	11	7	
G-3M ALU	34	11	7,5	
G-4	121	78	25	
G-5	100	48	20	
G-6	122	60	54	14
G-7	100	54	43	12
G-9	240	75	11	
GB-1 410x860	410	860		
GB-2 450x860	450	860		
GB-3 500x1000	500	1000		



NOMBRE	A (mm)	B (mm)	C (mm)	D (mm)
GB-4 550x1100	550	1100		
GB-5 435x1300	435	1300		
GB-6 670x1340	670	1340		
GBP-1 450x880	450	880		
GH-11 ZINC	71	16	38	
GH-12 ZINC	71	16	46	
GH-13 ZINC	73	17	26	
GH-14 ZINC	72	16	28	
GH-15 ZINC	81	16	30	
GH2 ZINC	62	38	26	
GH-4 ZINC	70	20	31	
GH-5 ZINC	41	15	14	
GR-1 M20 ZINC	136	56	20	
H TIR-14 ZINC	99	23	39,5	20
H TIR-7 ALU	100	39,5	30	
H TIR-7 BD	96	41		
H TIR-7 BG	100	41		
H TIR-7 INOX	94	39		
H TIR-9 ZINC	92	27	32	
H-1	103	45	32	20
H-10	131	36	18	
H-13	74	40	18	
H-15	155	34	18	
H-16 ALU	220	72	18	
H-16 ZINC	225	72	18	
H-18	170	52	28	
H-2	90	43	30	18
H-20	125	58,5	36	
H-28	180	49	22	
H-3	77	38	31	18
H-40	103	35	14,5	
H-41 ZINC	115	39	16,5	
H-5	156	40	20	
H-5 G	155	40	20	10
H-6	122	33	16	
H-7	91	33	16	
HB-1	180	105	13	
HB-2	215	140	13	
HH-10	130	39	18	
M TIR-11 ZINC	107	24	46	
M TIR-14	91	33	15	
M TIR-7 INOX	98	23	17	14
M TIR-7 ZINC	98	23	17	14
M TIR-9 ZINC	90	21	12	
M-1	127	71	34,5	19
M-2	200	135	35	18

NOMBRE	A (mm)	B (mm)	C (mm)	D (mm)
M-3	170	118	33	17
M-4	123	70	31	17
M-40	128	84	30	14
M-41 ZINC	142	93	37	15
M-5	132	75	34	17
M-6	114	67	31	15
M-8	15	69	30	15
M-8 G	25	71	31	15
P-0	400	60	32	
P-1	290	60	31	
P-2	240	50	25	
P-3	205	40	25	
Perfil-1 20x500 PVC	5000	20		
Perfil-2 20x400 PVC	4000	20		
Perfil-3 30x500 PVC	5000	30		
Perfil-4 30x400 PVC	4000	30		
Perfil-5 25x500 PVC	5000	25		
PLAC-1 ZINC	730	50	148	
PLF-1	545	145	110	
PLT-1 ZINC	40	18	6	8
PLT-2 ZINC	95	18	6	8
PLT-3 ZINC	135	18	6	8
RJ-48	385	48		
RJ-60	460	60		
RP-10 ZINC	540	415	25	
RP-11 ZINC	480	305	28	
RPH-1 ZINC	63	50		
RPH-2 INOX	81	60		
RPH-2 ZINC	81	60		
RPM-1 ZINC	57	57	95	
RPM-2 INOX	80	65	88	
RPM-2 ZINC	65	55	92	
S TIR-11	43	46	5	
S-1	50	40	6	
S-2	50	43	6	
S-3	50	40	6	
SBD-1 Z	450	120		
SBO-1	100	94	88	25
SBR-1	100	97	69	
SC-1	112	110	72	
SC-10 ZINC	80	35	27	10
SC-11 ZINC	53	30	21	10
SC-2	90	81	41	
SC-3	124	45	60	
SC-4	68	74	56	
SC-6 ZINC	120	60	14	10



NOMBRE	A (mm)	B (mm)	C (mm)	D (mm)
SC-7 ZINC	124	50	15	13
SHB-1	71	24	56	13
SICT	75	55	58	23
SRA-1 ZINC	340	40	30	
SRA-3 ZINC	760	102	77	41,5
SRA-5	530	75	40	42
SSCT	215	72	28	
SSCT-C	125	70	40	
T-1 5/8"	123	39	5/8"	
T-1 5/8" ZINC	123	39	5/8"	
T-10	326	33	16	
T-16	123	39	16	
T-16 ZINC	136	42	16	
T-2 3/4"	136	42	3/4"	
T-2 3/4" ZINC	136	42	3/4"	
T-20	137	42	20	
T-20 ZINC	150	46	20	
T-3 7/8"	150	46	7/8"	
T-3 7/8" ZINC	150	46	7/8"	
T-4 1"	154	46	1"	
T-4 1" ZINC	154	46	1"	
T-5	124	90	45	
T-5 ZINC	124	90	45	
T-6	81	69	34	
T-6 ZINC	81	69	34	
T-8	370	42	25	
T-9	290	34	20	
TG-0	115	75	90	
TG-1	195	80	80	
TG-2	240	80	90	
TG-3	350	100	100	
TG-4	490	80	80	
TIR 2 AP	70	95	55	
TIR AB	108	60	40	
TIR CD	86	80	54	
TIR-8 S/S ZINC	124	27	55	
TLH-50	315	100	40	50
TLH-60	315	100	40	60
TLH-70	315	100	40	70
TLH-80	315	100	40	80
TSC-10 ZINC	3000	130		
TSC-11 ZINC	3000	80		
TSC-2 ZINC	2350	42		
TSC-3 ZINC	2220	42		
TT-40 S/C	208	40	110	40
TT-48 R/F	178	90	170	48

NOMBRE	A (mm)	B (mm)	C (mm)	D (mm)
TT-60 C/C	245	50	150	60
TT-60 C/C DES	235	65	165	60
TT-60 C/CE	248	50	150	60
TT-60 RF	280	90	145	60
TT-60 RF/B	290	90	150	60
U-2	175	30	9	
U-2 ZINC	175	30	9	
U-3	130	23	7	
U-3 ZINC	130	23	7	
U-30	37	22	9	
U-4	107	18	6	
U-4 ZINC	107	18	6	
U-6	60	47	95	
U-6 ZINC	60	47	95	
U-7	38	50	71	
U-7 ZINC	38	50	71	
U-8	46	47	82	
U-8 ZINC	46	47	82	
U-9	24	78	74	
U-9 ZINC	24	78	74	
UB-1	78	58	30	14
UB-10	107	129	35	
UB-40	115	129	40	
UCA-1 ZINC	40	27	25	
UCA-2	41	30	22	
UCT	61	35		
UH 3/8"	140	30	7	
UH-10 ZINC	57	40	4	
UH-11 ZINC	68	40	4	
UH-12 ZINC	33	40	2	
UH-13 ZINC	75	40	2	
UH-14 ZINC	86	25	3	
UH-15 ZINC	83	25	3	
UH-20 ZINC	45	16	22	
UH-20.2 ZINC	100	30	30	
UH-31	32	20	30	
UH-4	102	19	5	
UV-2	228	160	68	
UV-2 S/S	228	130	38	25
VR-1 5/8" ZINC	1000	5/8"		
VR-16 ZINC	1000	16		
VR-2 3/4" ZINC	1000	3/4"		
VR-20 ZINC	1000	20		
VR-3 7/8" ZINC	1000	7/8"		
VR-4 1" ZINC	1000	1"		



**COMBINACION DE PIEZAS**

<b>CIERRES</b>	<b>UÑAS</b>
C-2 ZINC C-2 C-12 ZINC C-12	U-2 ZINC U-2 U-6 ZINC U-6 U-7 ZINC U-7
C-3 ZINC C-3 C-13 ZINC C-13	U-3 ZINC U-3 U-9 ZINC U-9
C-4 ZINC C-4 C-14 ZINC C-14 C-5 ZINC C-5	U-4 ZINC U-4
C-7 ZINC C-7	U-2 ZINC U-2 U-6 ZINC U-6 U-7 ZINC U-7 U-8 ZINC U-8
C-8 ZINC C-8	U-6 ZINC U-6 U-7 ZINC U-7 U-8 ZINC U-8
C-9 ZINC C-9	U-9 ZINC U-9
C-15 ZINC CH-30	U-30
CH-31	UH-31
CH-10 ZINC CH-10.2 ZINC	UH-10 ZINC UH-11 ZINC
CH-21 ZINC	UH-13 ZINC UH-12 ZINC
CH-14 ZINC CH-15 ZINC	UH-15 ZINC UH-14 ZINC
CH-20 ZINC	UH-20.2 ZINC UH-20 ZINC
CH-8 CH-3	UH-3/8"
CH-4	UH-4

<b>HEMBRAS</b>	<b>MACHOS</b>
CB-1	UB-1
CR-1	H-5
CR-2	H-10
CR-5	H-5
CR-6	H-10
CR-6 ALU	H-16 ALU
CRH-6	HH-10
H-1	M-2
H-10	M-5
H-13	M-6 ; M-8
H-15	M-5
H-16 ZINC	M-3
H-2	M-3
H-3	M-4
H-40	M-40
H-41	M-41 ZINC
H-5	M-1
H-5G	M-1
H-6	M-6
H-7	M-8
H-7	M-8 G